

ENGINE 604.910 #0 up to 063017,  
604.910 #2 up to 014106,  
604.912 #0 up to 018034,  
604.912 #2 up to 005010

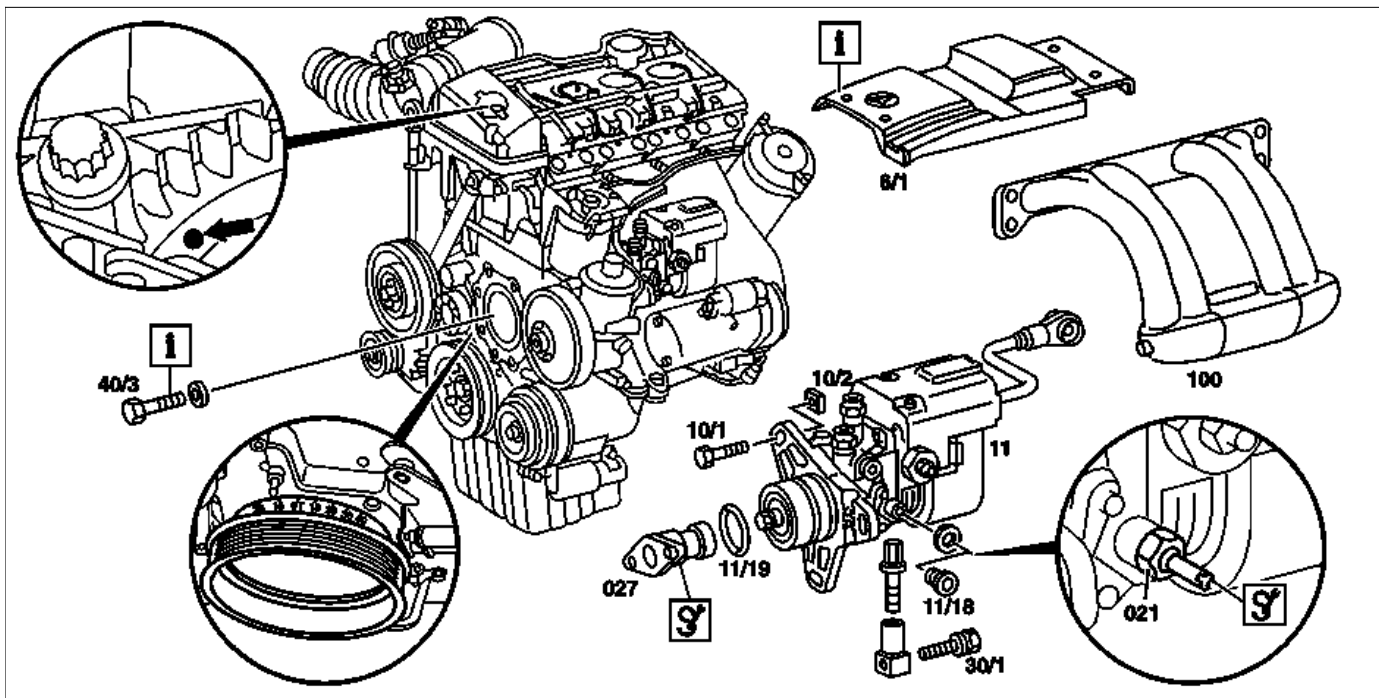

P07.13-0445-09

| ☒☒ | Removing, installing   |   |  |
|----|--|---|--|
| 1  | Remove intake manifold   |   | AR09.20-P-1310H  |
| 2  | Remove injection lines   |   | AR07.12-P-9230H  |
| 3  | Remove vacuum pump   |   | AR43.05-P-1320A  |
| 4  | Loosen central fixing bolt (40/3)  | Nm ⓘ Left-hand thread   | *BA07.02-P-1002-01A  |
| 5  | Turn crankshaft in direction of rotation to $14^{\circ} +0.5^{\circ}$ after ignition TDC of No. 1 cylinder | <p>ⓘ To do this open oil filler cap. Turn crankshaft until the marking (for center punch point, refer to figure) on the inlet camshaft gear is visible through the oil filler opening. Turn crankshaft further in the direction of rotation until <math>14^{\circ} +0.5^{\circ}</math> after ignition TDC of No. 1 cylinder</p> <p>☒</p>  | *001589650900  |
| 6  | Unscrew central fixing bolt (40/3)   |   | AR05.10-P-7800HA   |
| 7  | Remove chain tensioner   |   | AR05.10-P-7800HA   |
| 8  | Pull off injection pump coupling at connector  | To do this, press in lug on coupling and detach right-hand cover behind the splash wall and cable duct on firewall  | *BA07.02-P-1004-01A  |
| 9  | Unscrew bolts (10/1)   | Nm ⓘ Hold four-point nuts (10/2) securely   | *BA07.02-P-1004-01A  |
| 10 | Loosen bolt (30/1) on start of delivery adjusting device   |   |  |
| 11 | Remove injection pump  | <p>ⓘ <b>Installation:</b> Unscrew screw plug (11/18). Turn injection pump with serrated socket wrench 027 and lock with arresting screw 021. Check if the engine is at <math>14^{\circ} +0.5^{\circ}</math> after ignition TDC of No. 1 cylinder (refer to figure), correct if necessary. Only turn engine in direction of rotation.</p> <p>Ⓜ Remove arresting screw 021 after installing the injection pump otherwise the injection pump will be damaged when starting the engine</p> <p>Nm ⓘ Screw plug (11/18)</p> <p>☒</p> <p>☒</p> | <p>*BA07.02-P-1006-01A</p> <p>*601589000800</p> <p>*604589002100</p> |
| 12 | Replace O-ring (11/19)   | ⓘ <b>Installation:</b> Lubricate O-ring (11/19) before installing the injection pump  |  |

|    |                          |                |
|----|--------------------------|----------------|
| 13 | Install in reverse order |                |
| 14 | Check start of delivery  | dh0b04p100041x |
| 15 | Adjust start of delivery | dh0b05p100043x |

**Nm** Injection pump, unit pump, high-pressure pump

| Number             | Designation                              |    | Engine<br>604 |
|--------------------|--|----|---------------|
| BA07.02-P-1002-01A | Central fixing bolt, injection pump      | Nm | 45            |
| BA07.02-P-1004-01A | Bolt, front of injection pump M8         | Nm | 25            |
| BA07.02-P-1006-01A | Screw plug on distributor injection pump | Nm | 25            |

**Nm** Fuel preheater

| Number             | Designation                 |    | Engines 602.982/983,<br>603.971, 604,<br>605 except 605.911<br>606 except 606.910 |
|--------------------|-----------------------------|----|---|
| BA47.21-P-1001-01A | Bolt on fuel heat exchanger | Nm | 10  |

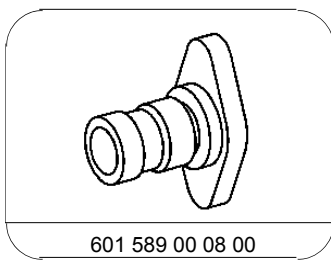

601 589 00 08 00

Serrated socket wrench

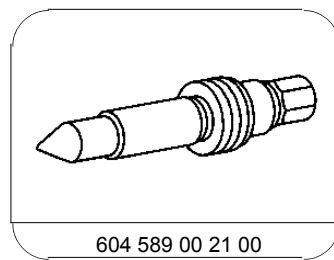

604 589 00 21 00

Arresting screw

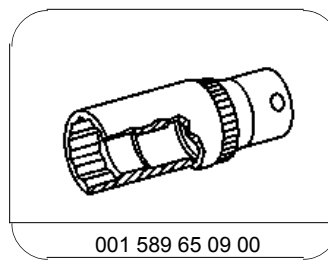

001 589 65 09 00

Wrench socket